

NO. OF CONTACTS	A MAX	B BSC	C MAX	D MAX
9	.785	.565	.400	.402
15	.935	.715	.550	.552
21	1.085	.865	.700	.702
25	1.185	.965	.800	.802
31	1.335	1.115	.950	.952
37	1.485	1.265	1.100	1.102
51	1.435	1.215	1.050	1.052
100	2.170	1.800	1.442	1.508

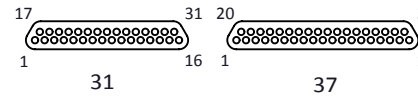

MATING FACE

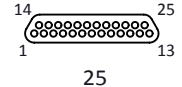
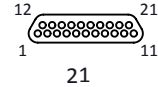
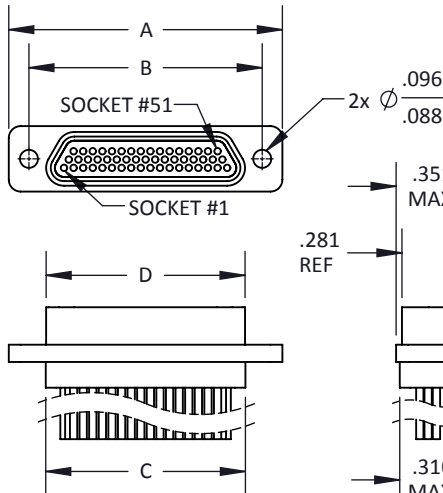
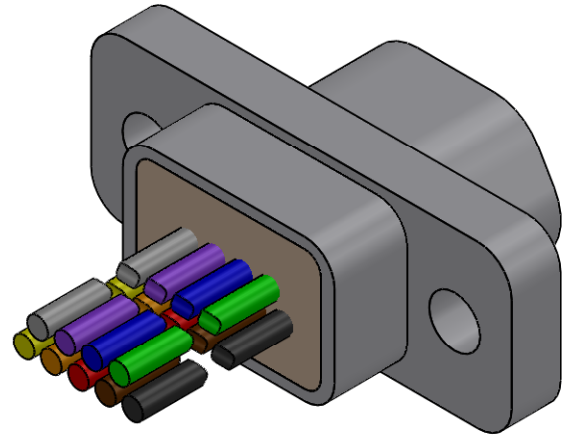

51 CONTACTS

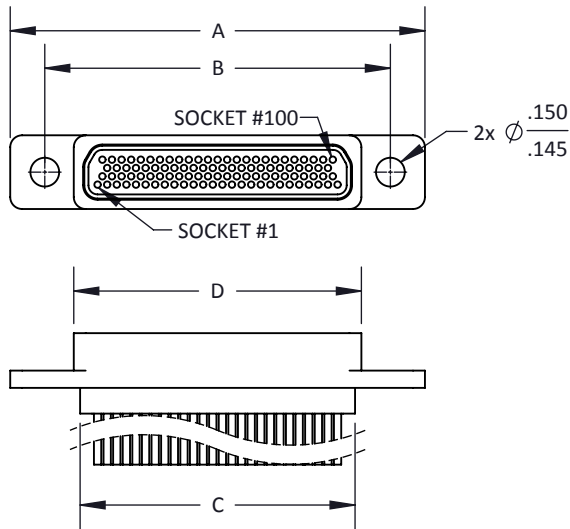

100 CONTACTS

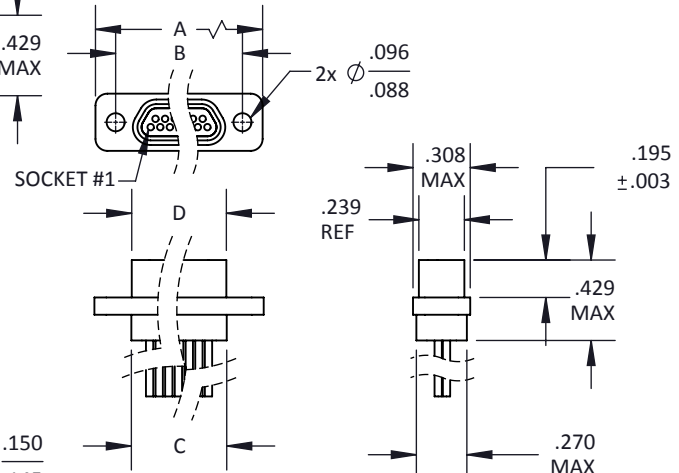

9-37 CONTACTS

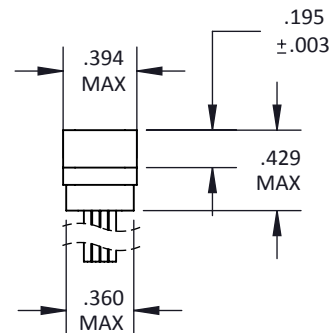

TOLERANCE: .XXX ±.005
.XX ±.01
ANGLE ±1°

TITLE
MICROMINIATURE D METAL SHELL
RECEPTACLE, CRIMPED-PREWIRED

SHT 1 OF 2

DWG. NO.
M83513/04

REV
G

WIRE OPTIONS TABULATION BLOCK						
LENGTH	+1.00 -0.00			+0.020 -0.000		WIRE TYPE
	18"	36"	72"	.5"	1.0"	
DASH NUMBER	01	02	13	/	/	M22759/11-26-9 (ALL WHITE)
	03	04	14	/	/	M22759/11-26-*** COLOR CODE PER M83513
	09	10	15	/	/	M22759/33-26-9 (ALL WHITE)
	11	12	16	/	/	M22759/33-26-*** COLOR CODE PER M83513
	/	/	/	05	/	QQ-W-343, TYPE S 25 AWG GOLD PLATE .000010" MIN
	/	/	/	/	06	QQ-W-343, TYPE S 25 AWG GOLD PLATE .000010" MIN
	/	/	/	07	/	QQ-W-343, TYPE S 25 AWG TIN/LEAD PLATE .000100" MIN
	/	/	/	/	08	QQ-W-343, TYPE S 25 AWG TIN/LEAD PLATE .000100" MIN

CIM 04 - X XX X

CRISTEK'S P/N EQUIVALENT
TO M83513 MIL SPEC.

RECEPTACLE, CLASS M,
CRIMPED PRE-WIRED NON-REMOVABLE
SOCKET CONTACTS

NUMBER OF CONTACTS
A = 9 D = 25 G = 51
B = 15 E = 31 H = 100
C = 21 F = 37

WIRE OPTIONS
SEE TABULATION BLOCK

SHELL FINISH
C = CADMIUM
N = NICKEL

MATERIALS AND FINISHED ARE IAW MIL-DTL-83513
FOR DETAILS SEE MIL SPEC OR WWW.CRISTEK.COM

1. MATERIALS:

SHELL - ALUMINUM ALLOY
INSULATOR - GLASS FILLED THERMOPLASTIC
SOCKET CONTACT - COPPER ALLOY
INTERFACE SEAL - FLUOROSILICONE BLEND

2. FINISH:

SHELL - ELECTROLESS NICKEL OR CADMIUM OVER
ELECTROLESS NICKEL
SOCKET CONTACT - GOLD OVER NICKEL

3. SPECIFICATIONS:

CURRENT RATING ----- 3 AMPS MAX
TEMPERATURE RATING ----- -55° C TO +125° C
INSULATION RESISTANCE ----- 5000 MEGOHMS MIN
DWV AT SEA LEVEL ----- 600 VAC
DWV AT 70,000 FT ALTITUDE ----- 150 VAC
CONTACT RESISTANCE ----- 8 MILLIOHMS MAX AT 2.5 AMPS
26 AWG (STRANDED) = 28 MILLIOHMS MAX
24 & 25 AWG SOLID = 25 MILLIOHMS MAX
CONTACT RETENTION ----- 5 lb MINIMUM AXIAL LOAD
ENGAGEMENT FORCE ----- 6 oz MAX
SEPARATION FORCE ----- 0.5 oz MIN

4. ADDITIONAL INFORMATION:

FOR CROSS-REFERENCING CRISTEK PART
NUMBERS TO M83513, SEE CROSS REFERENCE
INFORMATION IN THE FRONT OF THIS SECTION.
FOR MOUNTING HARDWARE OPTIONS, SEE THE
HARDWARE PAGES AT THE END OF THIS SECTION

TOLERANCE: .XXX ±.005
.XX ±.01
ANGLE ±1°

TITLE
**MICROMINIATURE D METAL SHELL
RECEPTACLE, CRIMPED-PREWIRED**

SHT 2 OF 2

DWG. NO.
M83513/04

REV
G